

Roller Mortise Lock with 60mm Backset

- The Platinum Collection Mortise Lock features:*
- Roller self latching latch to allow the door to operate by a push or pull action.
 - Three point deadlocking with two bolt throw settings:
 - The first setting suits door jambs that are narrow or have glass inserts.
 - The second setting fully extends the bolts for thicker jambs.
 - Heavy duty 1.6mm thick strikes with a radius leading edge for smoother latch operation.
 - Two strikes supplied to suit Left or right hand opening doors.
 - Sealed Lock case to prevent debris and saw dust from entering the lock body.
 - Includes strike dust box for optional use.

We recommend that you refer to the diagrams on this page as your templates for installing this mortise lock.

- Installation tips:**
- You will need to determine the handing of the door so that you use the correct striker template.
 - Refer to the "HANDING DIAGRAM" to determine the handing of your door.
 - The height of the mortise lock in the door will depend on the style of the door, any existing preparations or personal preference.
 - When drilling the holes for the mortise lock cavity, we recommend that you mark the drill bit or spade bit to ensure the correct depth is achieved.
 - There is a "strike dust box" supplied for optional use.
 - When drilling holes through the door, it is a good idea to drill holes from both sides of the door to avoid splintering.

HANDING DIAGRAM

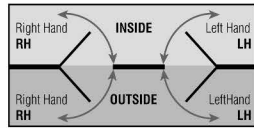
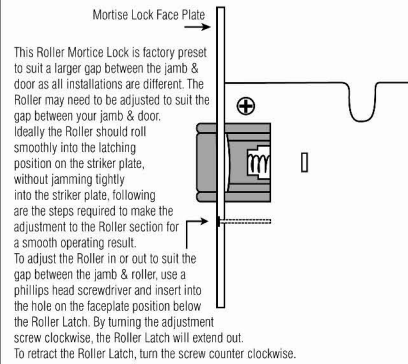
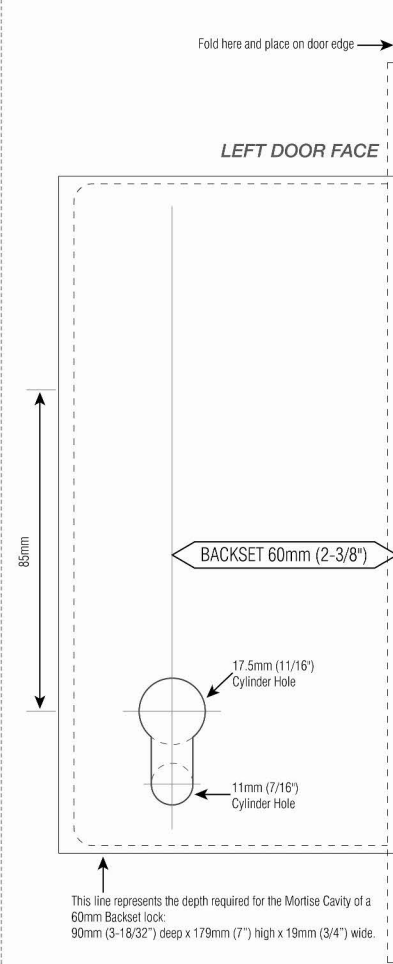

DIAGRAM 1.
Adjustable roller latch



ROLLER MORTISE LOCK WITH 60mm BACKSET



This line represents the depth required for the Mortise Cavity of a 60mm Backset lock: 90mm (3-18/32") deep x 179mm (7") high x 19mm (3/4") wide.

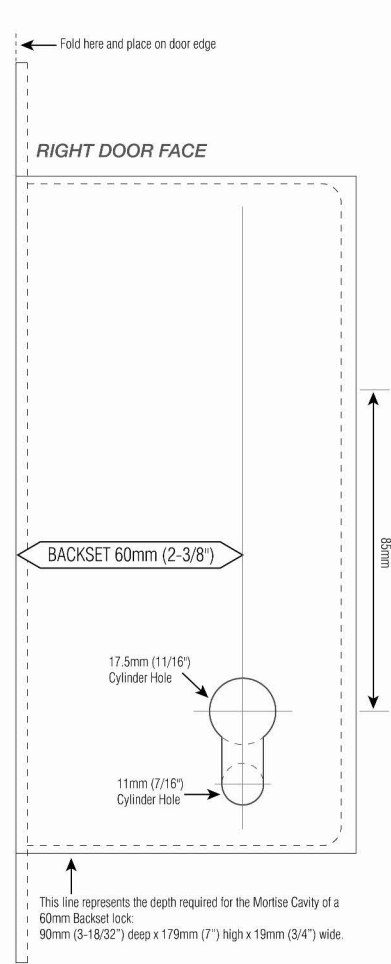
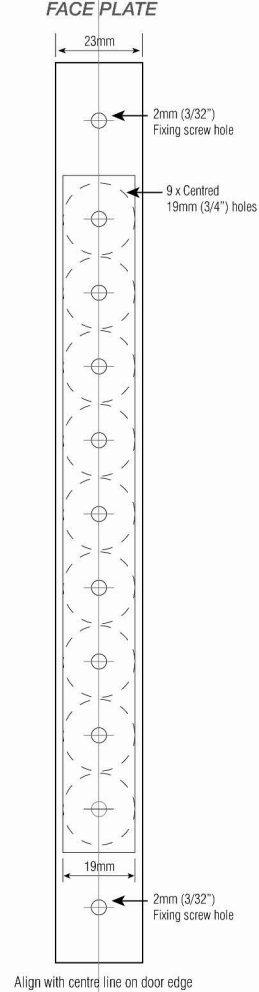

This line represents the depth required for the Mortise Cavity of a 60mm Backset lock: 90mm (3-18/32") deep x 179mm (7") high x 19mm (3/4") wide.

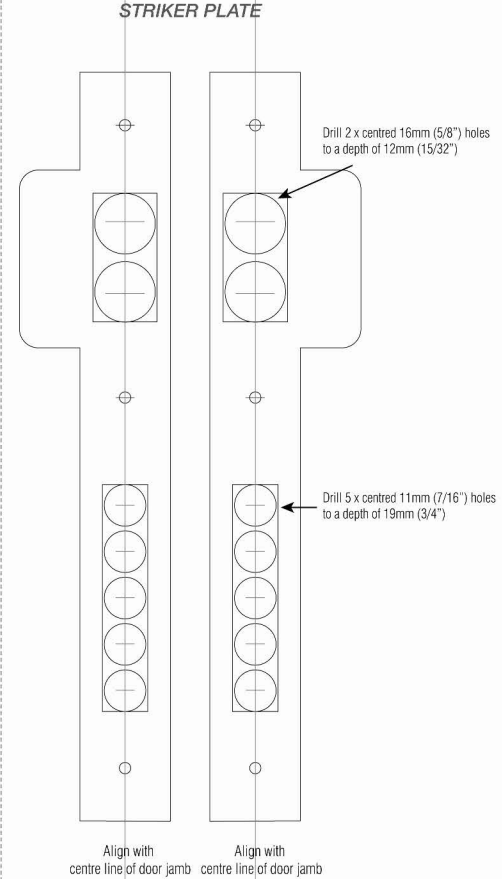

Choose the Striker to suit your door handing

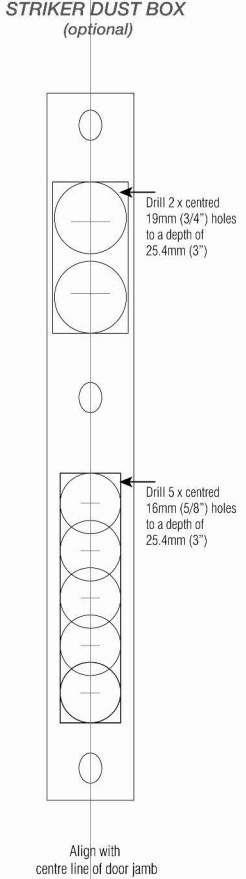

Mortise Lock with 45mm Backset

The Platinum Collection Mortise Lock features:

- Reversible latch to suit left and right hand opening doors.
- Three point deadlocking with two bolt throw settings.
The first setting suits door jambs that are narrow or have glass inserts.
The second setting fully extends the bolts for thicker jambs.
- Heavy duty 2mm thick strikes with a radius leading edge for smoother latch operation.
- Two strikes supplied to suit Left or right hand opening doors.
- Sealed Lock case to prevent debris and saw dust from entering the lock body.
- Includes strike dust box for optional use.

We recommend that you refer to the diagrams on this page as your templates for installing this mortise lock.

Installation tips:

- You will need to determine the handing of the door so that you use the correct striker template. Refer to the "HANDING DIAGRAM" to determine the handing of your door.
- To hand your mortise lock to suit your required installation. Lift the 'gravity stop' and press the latch in behind the face plate and rotate 180 degrees. This will change the direction of the latch face to suit your door handing refer DIAGRAM 1.
- **NB:** The sloped edge of the latch faces towards the door jamb that will accommodate the strike.
- The height of the mortise lock in the door will depend on the style of the door, any existing preparations or personal preference.
- When drilling the holes for the mortise lock cavity, we recommend that you mark the drill bit or spade bit to ensure the correct depth is achieved.
- There is a "strike dust box" supplied for optional use.
- When drilling holes through the door, it is a good idea to drill holes from both sides of the door to avoid splintering.

HANDING DIAGRAM

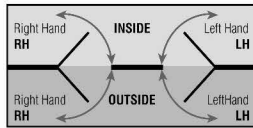
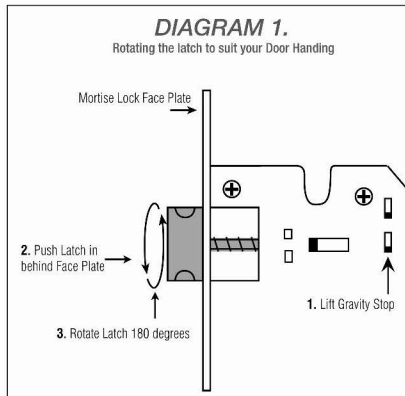
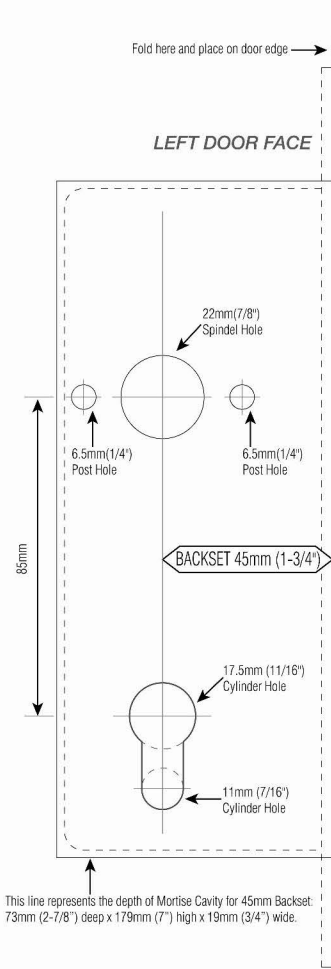

DIAGRAM 1.

Rotating the latch to suit your Door Handing



MORTISE LOCK WITH 45mm BACKSET



Align with centre line on door edge

